

# KRASOflex® Joint Tapes

## For building expansion joints and construction joints

+ DafStB waterproof concrete guideline: stress class 1 + 2

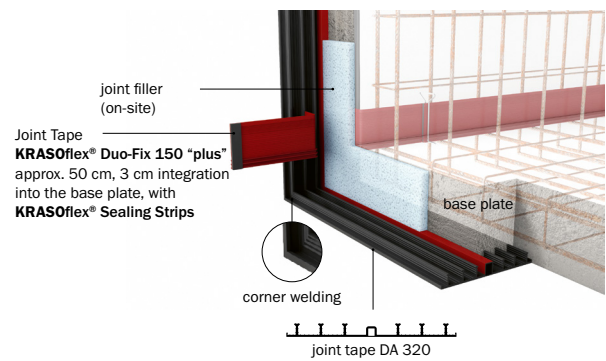

### KRASOflex® Building Expansion Joint T1 **LG 4**

base plate and wall separate

corner moulding: external expansion joint tape type DA 320 (under the base plate) on external expansion joint tape type Type DA 320 (wall) and on **KRASOflex® Duo-Fix 150 "plus"** as connection piece for surrounding **KRASOflex® Duo-Fix 150 "plus"**, anchor lengths 50 cm each (expansion joint tapes according to factory standard, DIN 18541 and DIN 18541 BV)

Item	KRASOflex® Building Expansion Joint T1
<b>KRASOflex® Building Expansion Joint T1</b>	Prices on request

**Scope of supply:** KRASOflex® Building Expansion Joint T1 incl. 2 KRASOflex® Mounting Clamps

JOINT TAPES

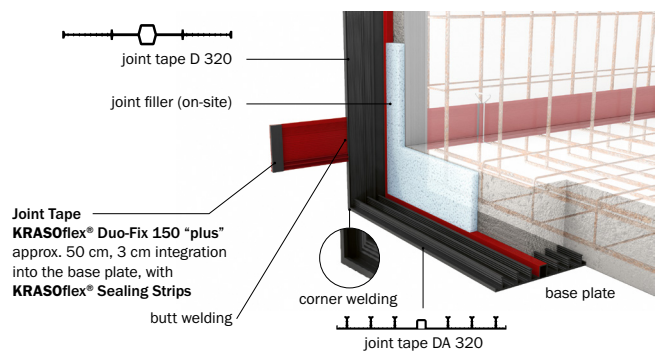

### KRASOflex® Building Expansion Joint T2 **LG 4**

base plate and wall separate

corner moulding: external expansion joint tape type DA 320 (under the base plate), on internal expansion joint tape type D 320 (wall), and on **KRASOflex® Duo-Fix 150 "plus"** as connection pieces, for surrounding **KRASOflex® Duo-Fix 150 "plus"**, anchor length 50 cm each (expansion joint tapes according to factory standard and DIN 18541)

Item	KRASOflex® Building Expansion Joint T2
<b>KRASOflex® Building Expansion Joint T2</b>	Prices on request

**Scope of supply:** KRASOflex® Building Expansion Joint T2 incl. 2 KRASOflex® Mounting Clamps