

## TECHNICAL DATA SHEET

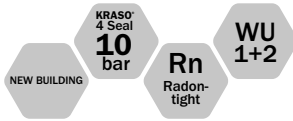

### KRASO® Yard-/Parking Level Drain with stainless steel grate Type 12.5

#### Application areas

Drain for the drainage of grey water, for installation in areas with traffic.

#### Technical details

- + In accordance with DIN EN 1253
- + Connection either for KG, HT or KG 2000 pipes DN 110, vertical drain
- + Load class B up to 12.5 t
- + Drainage capacity: 4.3 l/s
- + With frost proof odour barrier and removable sand trap basket, with grating approx. 19 x 19 cm (mesh size 21 x 22 mm)
- + Base plate thickness at least 15 cm

#### Tests

- + KRASO® 4 Seal - MPA-tested up to 10 bar!
- + IAF-tested: radon-tight!
- + DafStB waterproof concrete guideline: stress class 1 + 2



#### Material

Main body	ABS
Insert frame & grating	non-corrosive stainless steel V2A
4 seal	PVC

## TECHNICAL DATA SHEET

### KRASO<sup>®</sup> Yard-/Parking Level Drain with stainless steel grate Type 12.5

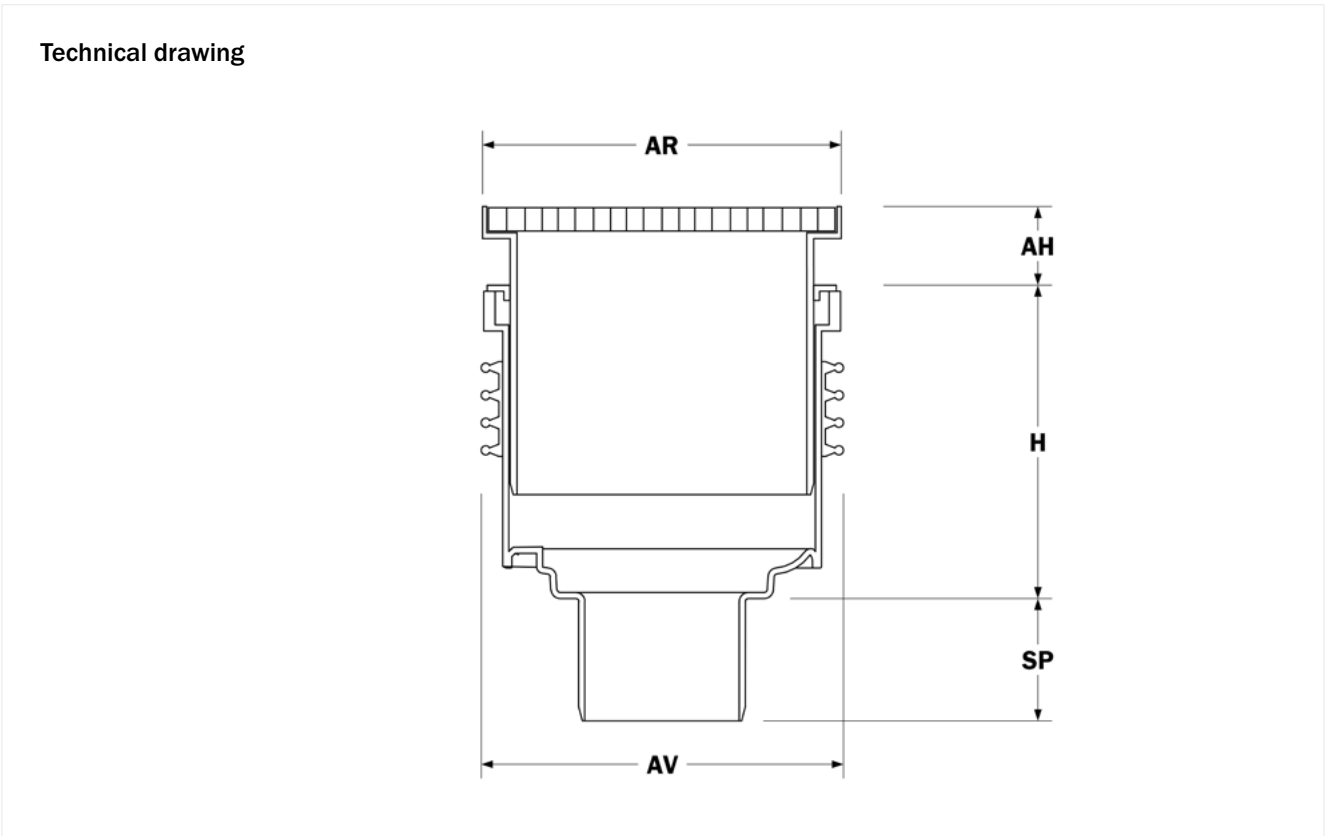

H = height main body | SP = spigot | AH = height insert frame | AR = insert frame | AV = 4 seal exterior

Item	H (mm)	SP (mm)	AH (mm)	AR (mm)	AV (mm)	Ø Pipe connection (mm)	Weight (kg)	Item no.
Yard-/Parking Level Drain with stainless steel grate Type 12.5	205	80	30 - 70	200 x 200	~238	DN 110	5.1	KHA125E